



mounting bracket 4VA stainless



terminal connection chamber „e“



II 2 G Ex d e IIC T5/T6  
II 2 D Ex tD A21 IP66 T95 °C/T80 °C  
-20 °C ≤ Ta ≤ +75 °C/+40 °C

Zone 1, 2, 21, 22

## Features

- visual signal device with powerful xenon tube for use in explosion endangered areas of zones 1 and 2
- modular system – synthetic housing made of glassfibre reinforced polyester
- low weight – robust and corrosion proof design
- flameproof chamber „d“ – terminal connection chamber in protection class increased safety „e“
- for continuous operation
- models with 5 or 15 J strobe energy
- 4 lens colours
- insulation class II – no equipotential bonding required

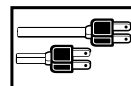

## Technical data

Type	dHF
Housing, Colour	glassfibre reinforced polyester black RAL 9005
Lens	polycarbonate (makrolon)
Lens colour	amber, red, blue, green (inner lens)
Terminal	1,5 mm <sup>2</sup> fine wire 2,5 mm <sup>2</sup> single wire
Cable entry	cable gland M20 x 1,5 and blind plug M20 x 1,5
Mounting	as required - swiveling mounting bracket
Strobe frequency/lifetime	~ 1 Hz, approx. 5 x 10 <sup>6</sup> flashes
Operation	continuous
Insulation class	II no equipotential bonding
Weight	5,9 kg
Approval	PTB 02 ATEX 1098



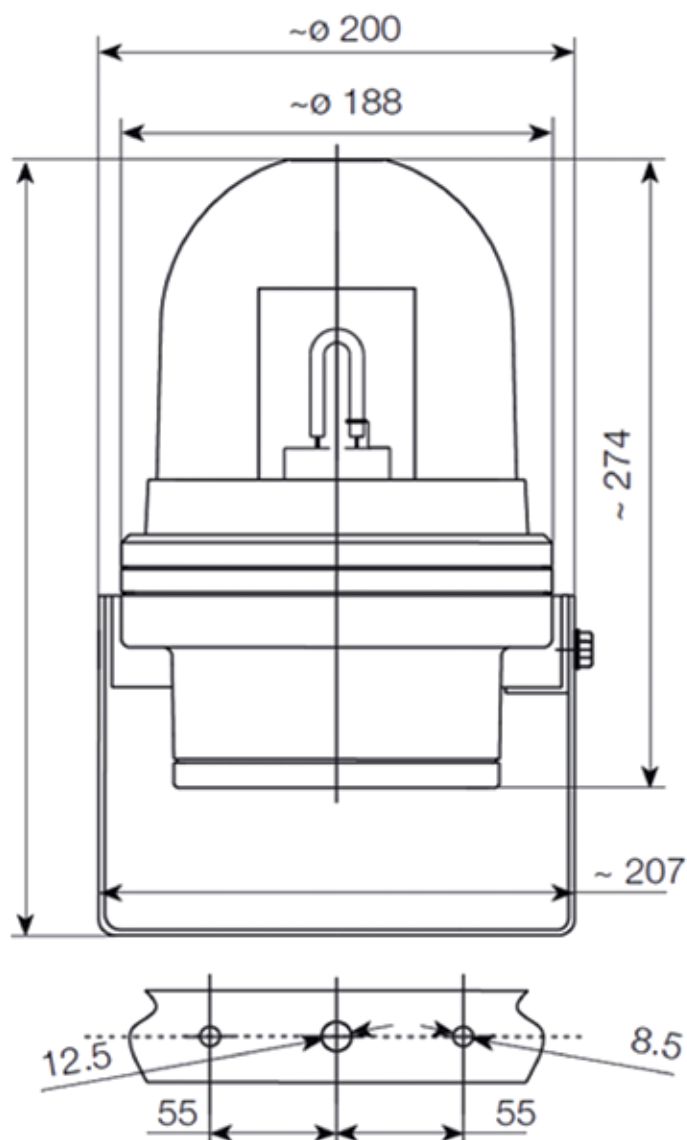

#### Colour code for lens

C

1	amber	5	blue
2	red	6	green



## Order data

Type	Order No.	Denomination	Strobe energy (J)	Nominal voltage	Voltage range	Nominal current (A)
dHF1	340 00C 413	Ex-proof strobe beacon	15	230/240 V AC 50-60 Hz	207-253 V AC	0,20
	340 10C 410		5	110/120 V AC 50-60 Hz	103-127 V AC	0,135
	340 10C 413		230/240 V AC 50-60 Hz	207-253 V AC	0,13	
dHF2	340 00C 005	Ex-proof strobe beacon	15	24 V DC	21-53 V DC	1,00
	340 00C 009			80 V DC	72-132 V DC	0,25
	340 10C 004		5	12 V DC	10-14 V DC	0,600
	340 10C 005			24 V DC	21-53 V DC	0,280
	340 10C 009			80 V DC	72-132 V DC	0,09